

NOTE: THIS PANO DEVICE WAS MADE FOR A LUMIX GH1 WITH 9-18MM LENS. YOU WILL NEED TO ADJUST THIS DESIGN TO FIT YOUR CAMERA AND YOUR LENS. IT IS IMPORTANT TO FIND THE NODAL POINT OF YOUR LENS! OTHERWISE YOU WILL GET PARALLAX ERROR. THIS DESIGN IS FOR CYLINDRICAL PANOS. IT WOULD NEED TO BE MODIFIED FOR SPHERICAL PANOS.

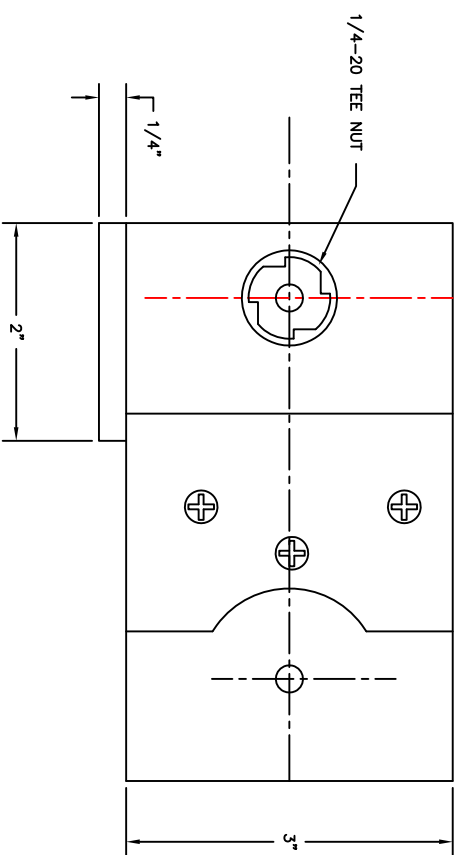

TOP VIEW